



ASSORTED
SKILLS +
TALENTS

Why the f*** work with us?

Architecture
Design
Strategy
Narrative
Communication

www.assortedskillstalents.com

Founded in 2017 by **Chris Boyce**, a well known + respected designer, architectural commentator + former Design Director of AJ100 top 10 practice....**blah blah blah...**

Nope, that's **NOT** why...

Here's why...

This bloke is Pete, he was a client of ours at **Blackburn with Darwen Council**...

...also a **friend**...

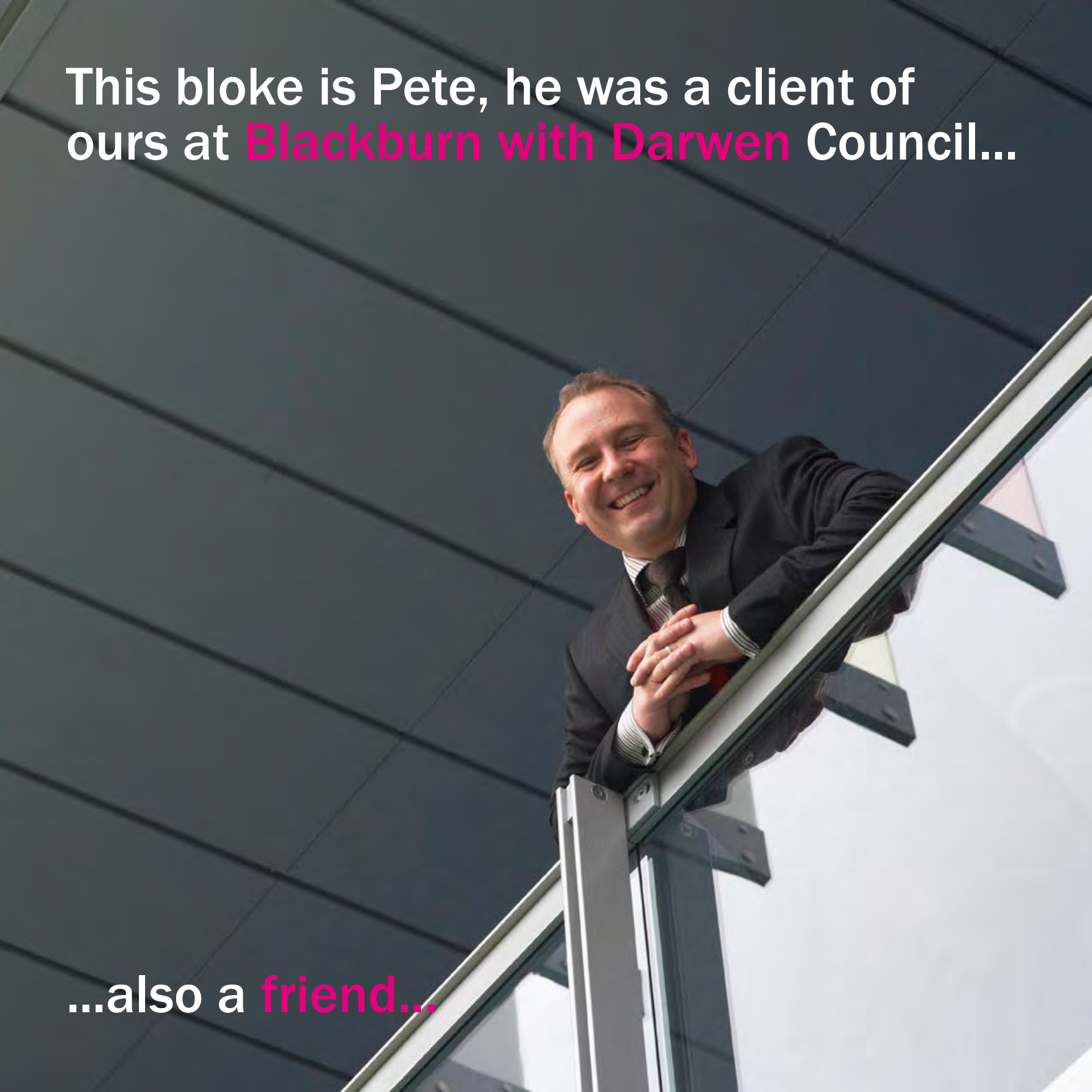

Pete urgently needed to replace a school, a **damp, dark + depressing** Victorian pile on a hillside in Blackburn. He had a limited budget + no time...



The coalition were new in power + planned to **stop all capital projects** in a few months.

What we created together was swift, **fun + changed lives.**

He helped us build this...

It's subtle...



In 2013 when the **Stirling prize long list** was news (for 10 min) this was the lead image in The Times, The Telegraph, The Independent, The Guardian and BBC News...



Its not subtle...but we can be...

But this is the image we carry in our minds when we think back to what we did at **St Silas School...**



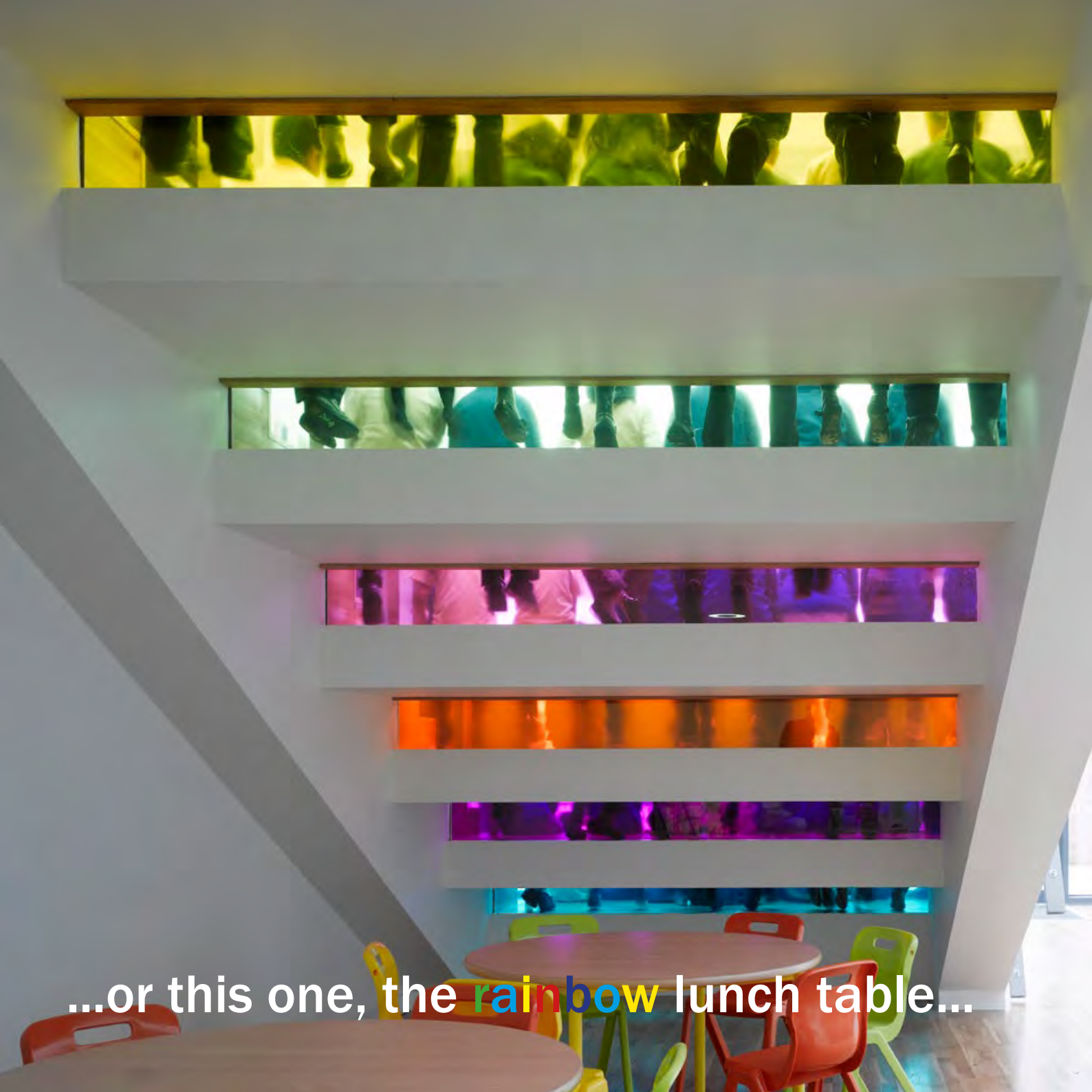

...or this one, the rainbow lunch table...



...or this one, of **“the secret”** classroom...

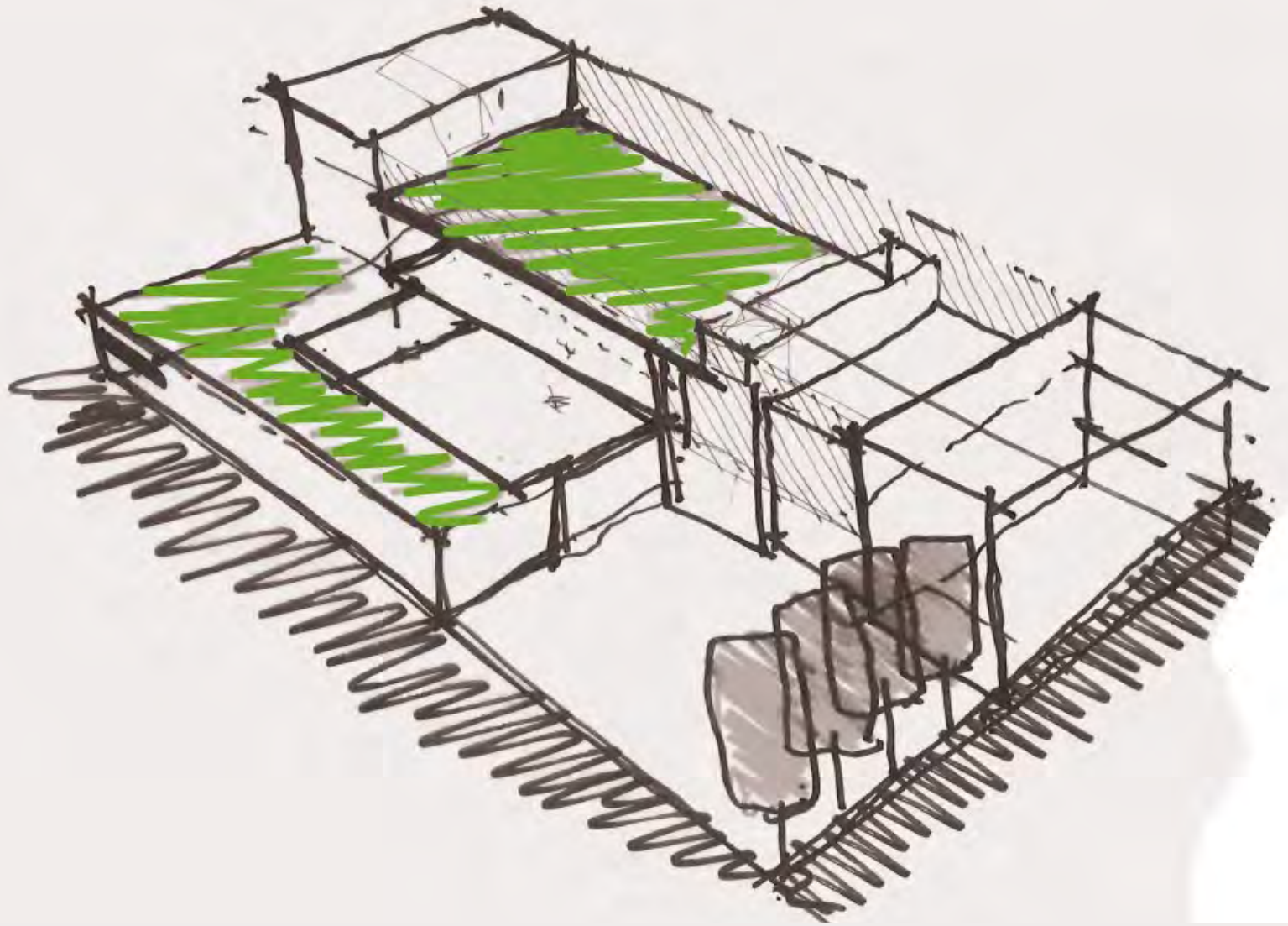

We made a school that worked like a little **jewellery box**, layering uses across the site to create multiple levels of activity...

...wrapped round a courtyard, that is both **transparent + secure**, each classroom focuses on that space, while public functions are linked across the site from a **new public space**.

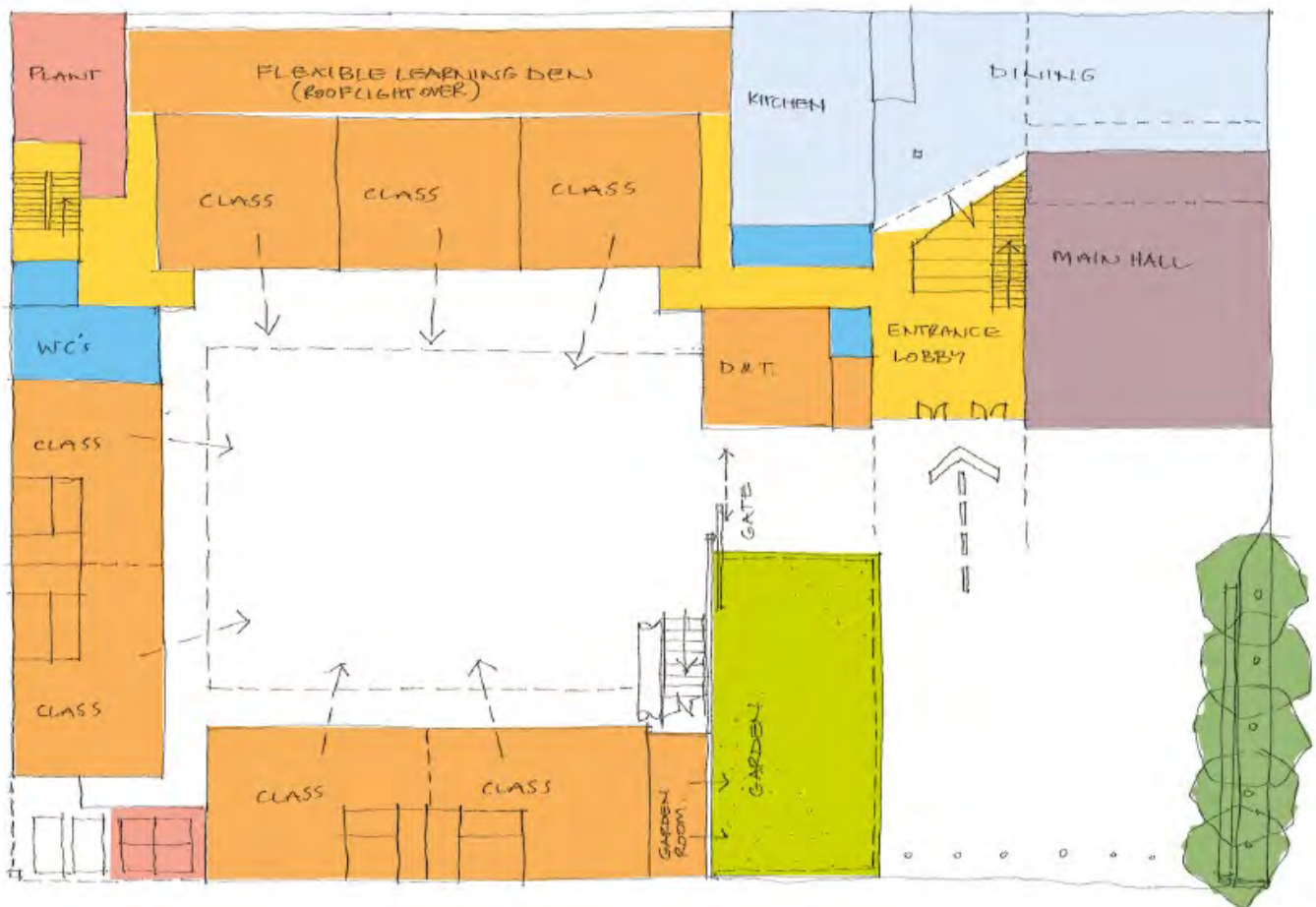



A tiny site where every square metre works **twice** as hard + each space interlocks to create **flexible** pedagogy...

...with an **astro pitch on the roof** + a mini race track in the courtyard...



A school for a **community**, which for cultural reasons didn't interact with the old school* at all...



*spot the original 19th Century door - which has a legend attached!

A school about breaking down physical
+ social barriers, **changing attitudes...**

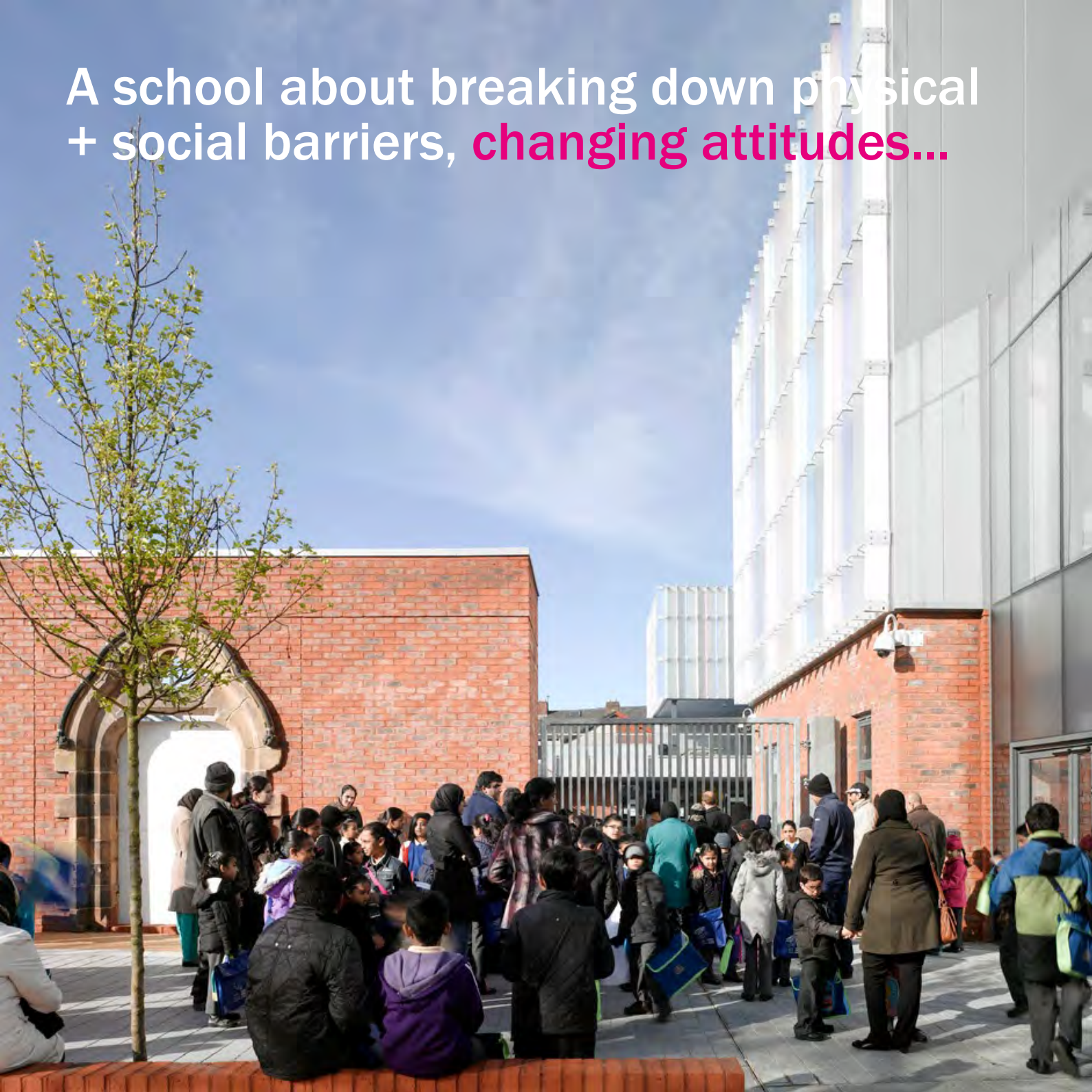

A school that has improved education outcomes + is **changing religious + cultural perceptions** for many; creating; a **school for everyone...**



It won us a few shiny **awards**, but we are most proud of the **RIBA client of the year** award for Hilary + Pete, because they let us **care** about the real clients, the kids who will learn here in years to come...

“We proved...that design matters, joy matters, and that the very best can be achieved with the right vision, and the best design team. Chris and Duncan made this school remarkable, within a tight budget. The kids love the school, and its so open, so easy for parents to come in now and take part; I love it.....”

Hilary Hinchcliffe - Head teacher



- **2013 RIBA Regional Award**
- **2013 RIBA National Award**
- **2013 RIBA Client of the year award**
- AJ Schools Special 2013 - front cover
- AJ Schools Special 2013 - 4 page feature
- June 2013 The Independent; “Education dominates; RIBA Stirling Prize” image leader/article
- June 2013 Guardian “If you build it: RIBA Stirling Prize long list” image leader/article
- Architecture Record China 6 page article
- June 2013 Times online “Stirling Prize” image leader
- **2013 Civic Trust Award (commendation)**
- 2014 North West Construction Award short-list
- 2014 Partnerships Awards “best designed project”



We made a school filled with love.

So who are we?

Based in Manchester + London, we pride ourselves on being **open** minded, non-specific, full of energy + sound of judgement.

We think in **space + light**, but we talk in **values/appraisals** + measurable outcomes. We **listen** first, then **listen** again.

We are social anthropologists, **story tellers** + urban explorers. We will fulfil your expectations + **challenge** you.

How can we say that?



Let us tell you another story...

We got a call one night, in 2017 from a client who did “big housing” with us about a **charity** she had become a trustee of in London...



They had a problem...

A **dilapidated** building in an **extraordinary** position on the River Thames; a rowing club dating from 1889. It needs some **love...**

The membership was aging, the future looked uncertain, but the club's history was one of **subversive** social revolution mixed with **sporting excellence...**

We won the competition, but had never designed a rowing club...

I mean, who has huh?





This is **much** worse than it looks.

But **why** just restore an elitist, posh boys playground?

Why not **do more?**

We developed a wider brief with the client to **reach out** beyond the club, beyond the fee paying schools who dominate access to the sport + to find a kid, from a very **different social + cultural background** who has never thought of rowing, never heard of it. **Why?**

Because we think **sport can effect social change**, when that is so hard to do these days...

Back in **1889** **Quintin Hogg** set up the Polytechnic Rowing Club (now the Quintin Boat Club) to **subvert** the rules of Henley Royal Regatta...



We know, this lot don't look **subversive**...

So we did some **magic thinking** via some **boring numbers** stuff with the Captain of the club, Mark. We had an **idea** as to how we could create **free rowing** for schools...

Boats	QBC (4)	KEW (1)	T1 (2)	T2 (3)	ad hoc boats	Total		
singles	81	6	10	14	0	111		
doubles	21	0	7	9	0	37		
triples	2	0	0	0	0	2		
quads	20	0	6	11	0	37		
VIII	9	4	1	8	0	22		
LTR	0	4	0	0	0	4		
Total Boats	133	14	24	42	0	213		
Youth/Outreach suitable (LTR + 2/3/4 VIII)	52	0	8	14	0	0		
River Time* hrs	104	0	16	28	0	56	204 hrs	
Coach Time** hrs	2.6	0.0	0.4	0.0	0.7	0.0	1.4	5.1 hrs
COMMITMENT COMMUNITY USE								
Weekday	10%	5%	5%	5%	5%	5%	% of coach time	
Weekend	20%	10%	10%	10%	10%	10%		
Monday	0.3	0.0	0.0	0.1	0.0	0.0	0.4 hrs	
Tuesday	0.3	0.0	0.0	0.1	0.0	0.0	0.4 hrs	
Wednesday	0.3	0.0	0.0	0.1	0.0	0.0	0.4 hrs	
Thursday	0.3	0.0	0.0	0.1	0.0	0.0	0.4 hrs	
Friday	0.3	0.0	0.0	0.1	0.0	0.0	0.4 hrs	
Saturday	0.5	0.0	0.1	0.1	0.0	0.0	0.8 hrs	
Sunday	0.5	0.0	0.1	0.1	0.0	0.0	0.8 hrs	
TOTAL	2.3	0.2	0.3	0.6	0.0	0.0	3.5 hrs per week (average)	
ANNUAL							180.18	

We showed that at the moment the site is hardly used at all (well apart from the end of the annual **Oxford v Cambridge** boat race) + that there was a LOT of **potential** to increase access...

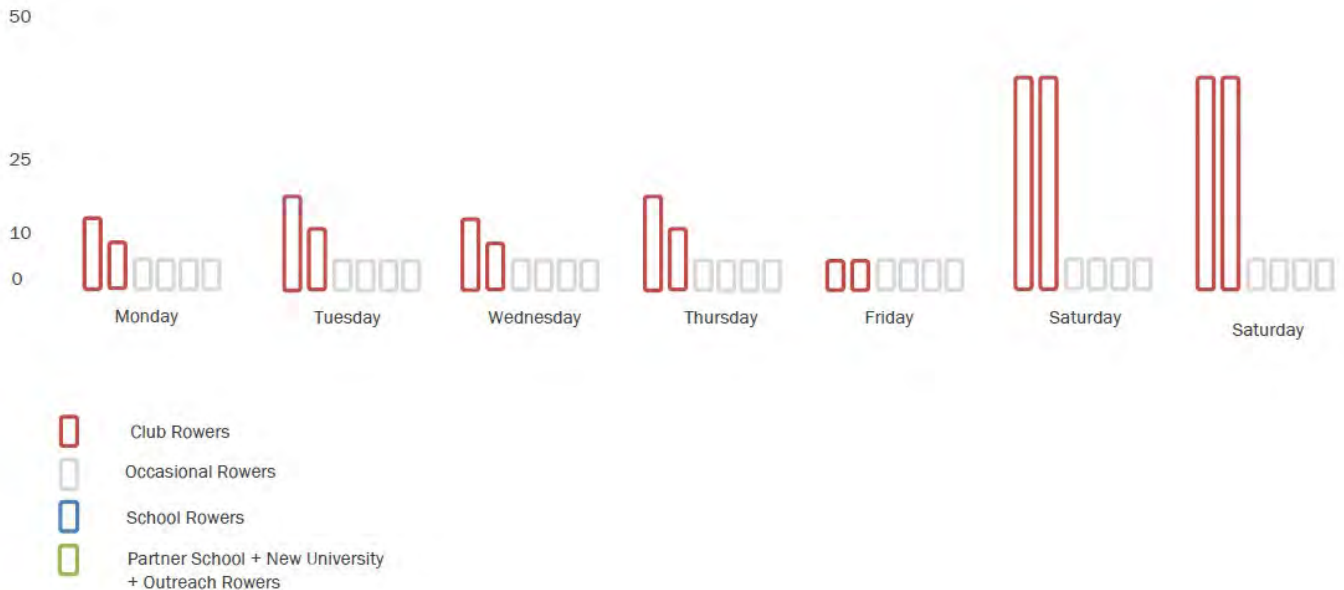



We just had to secure planning consent for the **200%** uplift in footprint on **Metropolitan Open Land**. The same land Sadiq Khan pledged to **protect** in 2016, as others have before...

By creating a **multi-zone** well managed carbon neutral **boat store**, filled with posh school's boats, where we could develop a **downtime "tithing"** of boats + coaching time to the **outreach programme**...

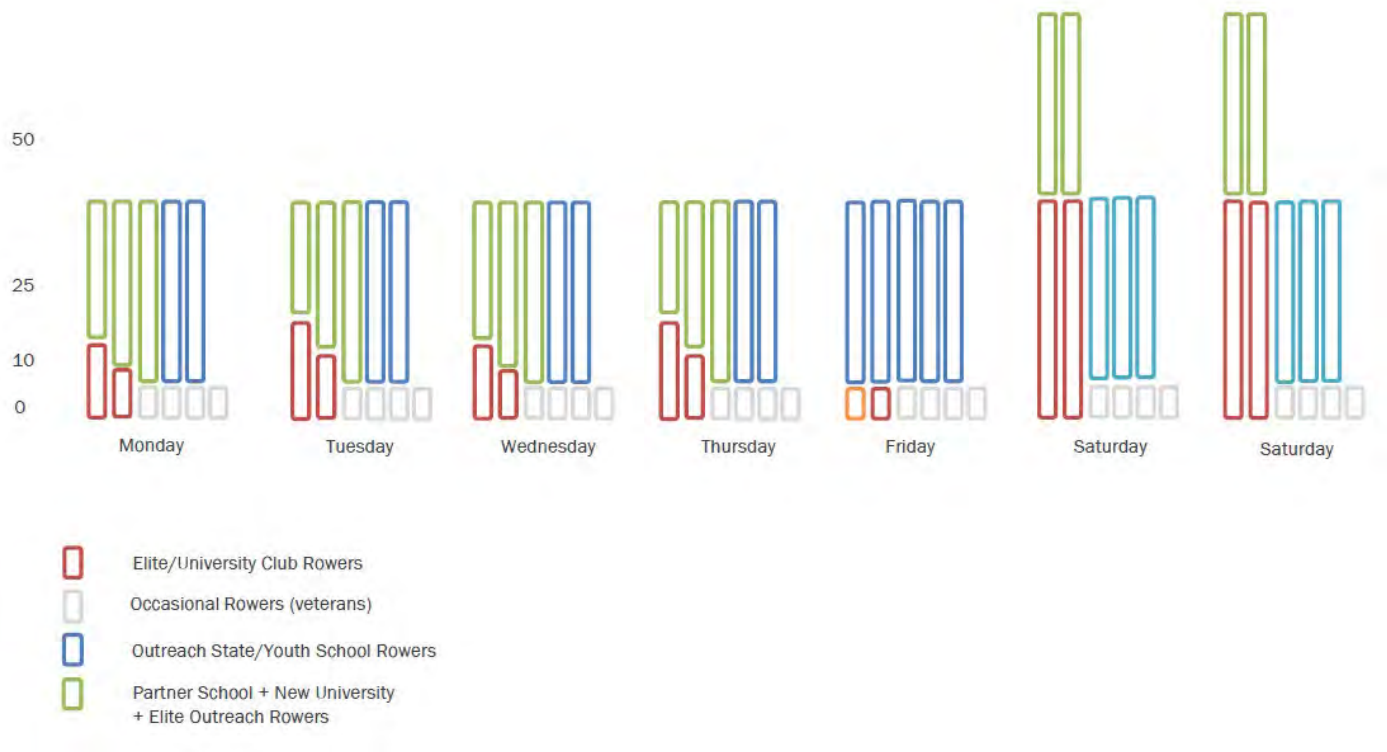

QBC partnered **London Youth Rowing** to develop the programme in 2020...



...and as we designed, that programme kicked off, in a small way. Eventually some **2000 non-fee paying** young rowers will come here annually...

...we threw in a new **Rugby Club facility** for the University of Westminster too, which will now be the basis of a partnership with **a major rugby club*** who are relocating to the site in 2025...



* it's a secret, cant tell you who yet...

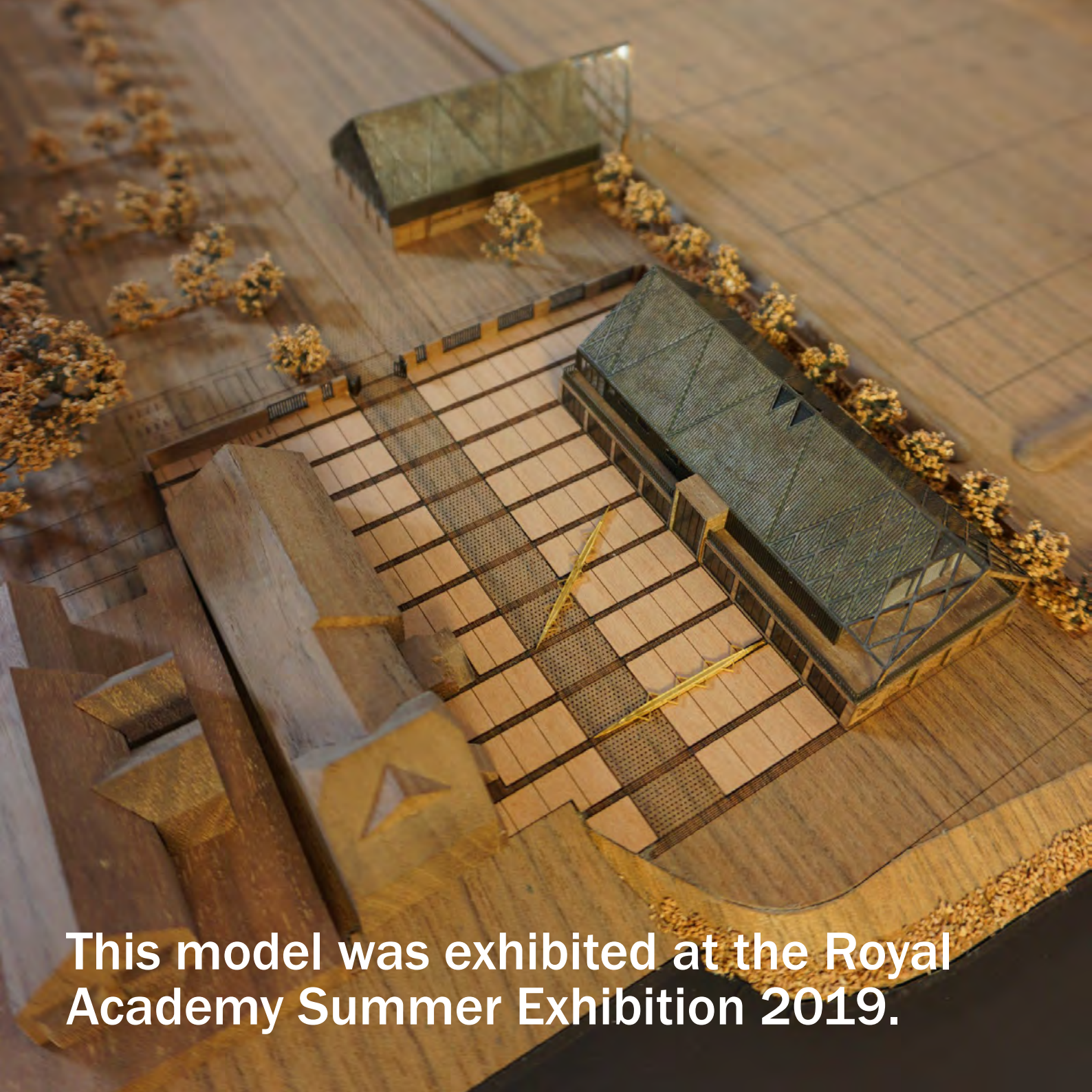

This model was exhibited at the Royal Academy Summer Exhibition 2019.



We got our consent after 18 months +
we **started on site in** May 2020.

So why are we showing **you** this?

We have worked across many scales + typologies, with the same **energy + love**.

From large scale **housing, masterplans + workplace** to mixed scale bespoke buildings for **culture, sport, transport + education**.

We have **made a mark** wherever we work.

We know we can offer you a **unique** view on the projects and places you create, across the UK...

Family + Friends...

Our practice came about through a mutual need to work on projects we **love**, for the people we **trust + respect**, with the people we **love**.

Our team is a **little family**.

We have won new clients, but are **proud** to be working with many who have known us for years.

We like to make an **impact...**

Here's another story...



We were **invited** to build a bus station for the St Silas School client **BwD council**...

We set out to **sculpt** a new canopy that would visually **poke** the town in the eye + explore a formal **echo** of the past (in this case drying cotton bolts) while being unashamedly of the **future**.

It is an **Instagram** star now :)





It is also a **distinct urban intervention** to free up a new development site...

Part **regeneration**/part transport we created a building that expresses **civic pride** in a town that suffers from a lack of it...





PS: we had never done a bus station station before

Making places to live in;

We know that **good place-making** is about creating different **tenure homes + communities, mixing spaces + people**; excellence is not easy.

As a practice/team the last 3+ years have often been about creating **places to live**, larger in scale + in our case all about the **spaces in between** the buildings.

We continue to work at this scale seeking the opportunities with clients to make **simple but well made homes** which become part of a city...

This is **Monkbridge**...in Leeds.





650 BTR homes alongside the canal and river just **10min** from the station...

We created a series of buildings along a **massive disused railway viaduct** which are linked by a new **800m park + public route** through...

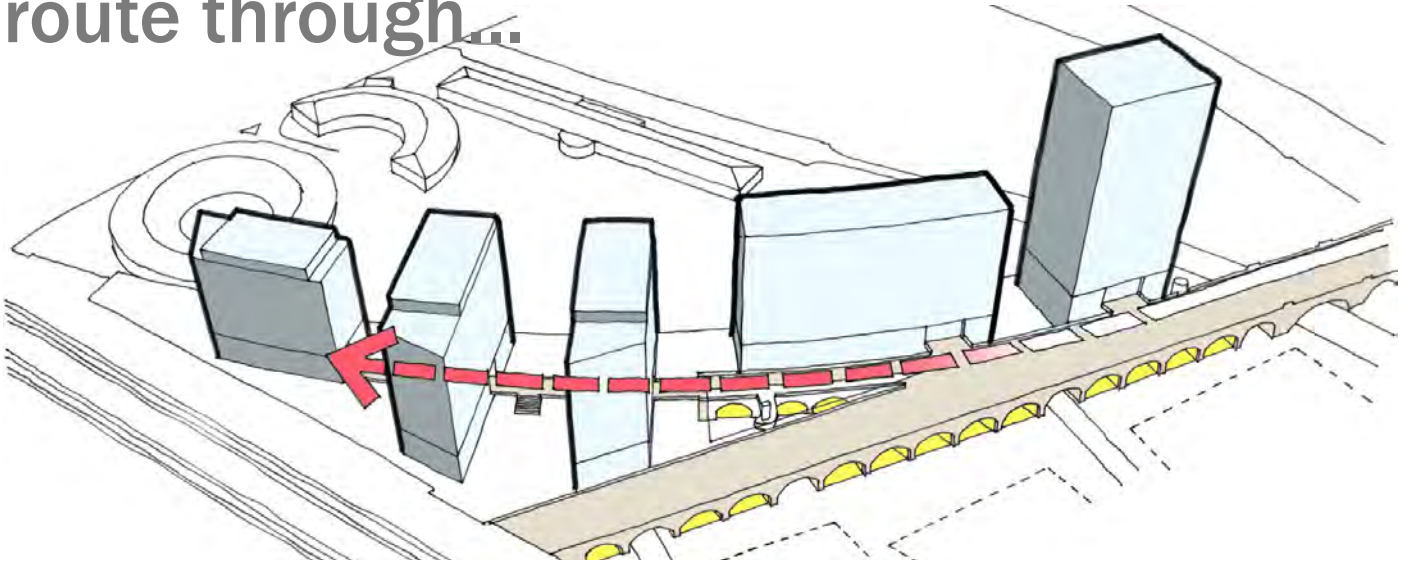



The **energy** of the spaces under the arches links via spiral stairs to the top level park; this is true **regeneration**...



We **masterplanned** the scheme from 2015, then undertook reserved matters in 2018. Driving **efficiency** by **creating 52 additional** homes...



Our **studio** today;



We continue to major on **low carbon development / retrofit / adaptive reuse** of existing buildings where we find them, such as this **agricultural building** near Rochdale...

This **adaptive reuse** will bring that old barn into the 21st Century + beyond...



...which we are
converting into
a new **Golf Club**
at an established
course, set
in a landscape
with over
50,000 trees...





As you enter the building the course is **framed** by the club house space + the green of the trees becomes a **backdrop...**



The club house features a **20m linear window seat** which overlooks the club's man made lake...

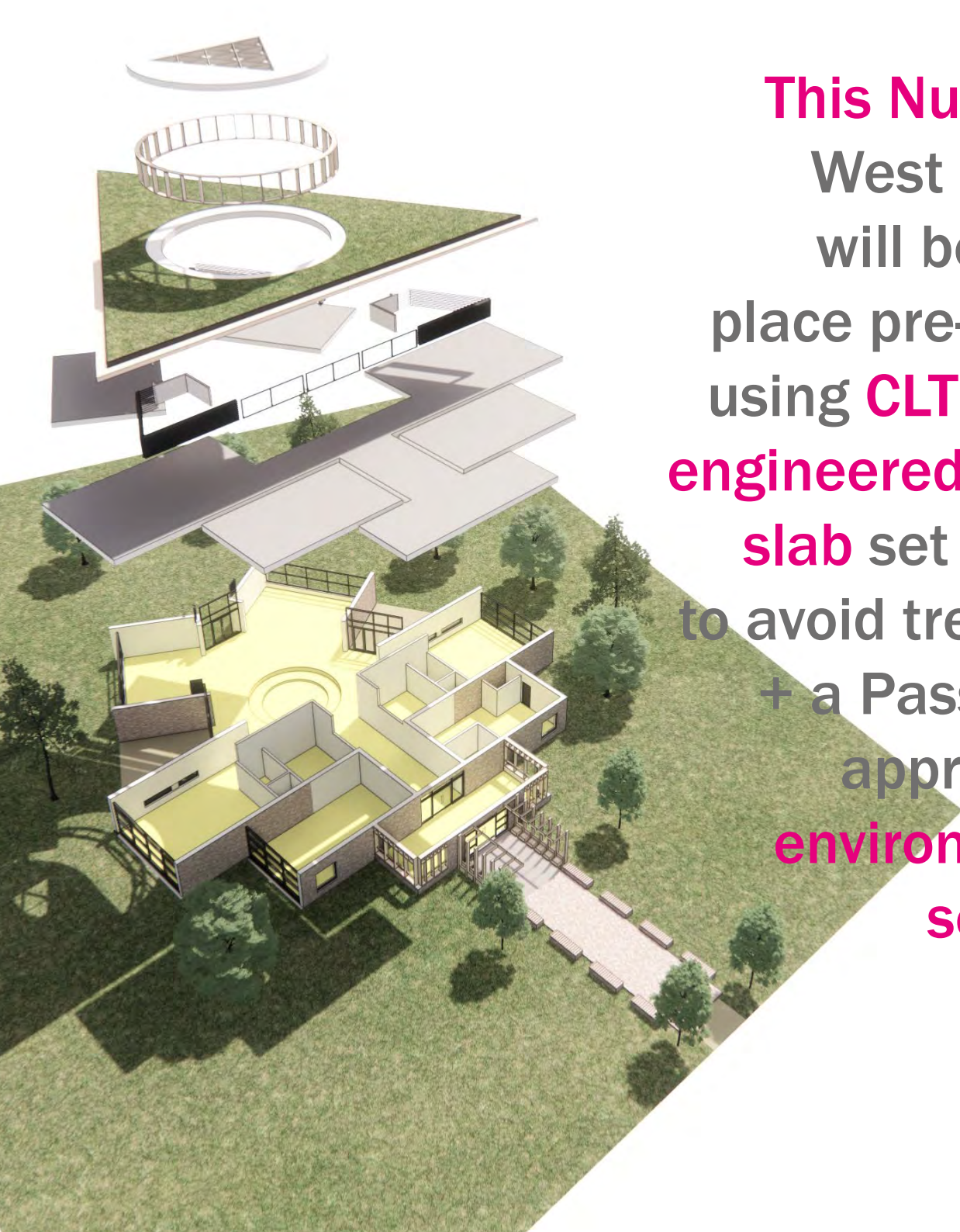

This Nursery in West London will be an 80 place pre-school, using **CLT and an engineered timber slab** set on pins to avoid tree roots + a Passivhaus approach to **environmental services.**



This timber frame **zero carbon in use / low embodied carbon** light manufacturing facility is our first industrial project...



So the **big question** is, why work with us?

What could we do for **you**?

How can we help you **shape** the future of this part of the city,

make new **places richer + impact** positively the lives of communities; why work with us?

We hope our **approach + philosophy** is clear, our design methods apparent; we have the **experience + skills**, we have the **talents**.

We **don't do predictable, don't have a house style**. We see each project as a **story** yet to be told...



Founded in 2017 by Chris Boyce, a well known and respected architectural commentator, designer and former Design Director for one of the UK's top 10 largest practices, we are a small collective of architects, designers + makers with Assorted Skills + Talents*. We are VR\3D\BIM capable, agile thinking, strategic advisors. We are nimble + rigorous. We innovate to create value for our clients. We are 3 x RIBA national award winners, 4 x Civic Trust Award winners and have delivered as a team for a decade. We are most proud of the buildings we have created that can change lives, schools and public commissions which enrich and challenge their users, making life easier or just by adding a sprinkle of delight.

Located in London & Manchester we are able to support you nationally and further a field if required.

Bring us your next challenge and let's enjoy the process.



Chris Boyce

Director + Founder

*The Glasgow School of Art Mackintosh School of Architecture (BArch)
Bartlett School of Architecture UCL (MArch)*

In summer of 2017 with the support of two key clients Chris started Assorted Skills + Talents* a new modern practice located in Manchester, and London where he lives.

An award winning leader, Project Director + Designer, Chris is former board Director for Capita|ESA (Architecture Environment and Planning), Design Director at CJCT architects and has over 20 years in the profession, including the first two years at the office of Sir James Stirling.

From master planning to commercial offices across civic, community and regeneration projects Chris has led teams ranging from a handful to large groups of cross discipline professionals, and was Design Director for Captia|ESA for six years when they ranked #5 in the AJ100.

Chris leads on the output of the practice taking a particular delight in the RIBA stage 0/1 work, the establishment of social and commercial agendas, stretching the role of architect to encompass brief writing, engagement and community based strategies to gain buy in based on trust and “social investment” from clients, as well as strategic design roles with wider bodies, across both local government and private developers.

A designer at heart he came to architecture from fine art and painting, and continues to draw daily, working on paper to establish design parameters. However new modes of communication of design are central to AST* with a fully BIM level 2 studio structure, VR/AR capability, prototyping physically and using digital model images to convey design process at each step.

Chris has found many areas where architects fail their clients as consultants because of their lack of real communication skills, being weak on the commercial drivers of those

clients, and a slowness in adapting to the modern process of delivering buildings in the 21st Century.

Old fashioned methods are risky and can lead to problems in delivery, where modern BIM tools used from RIBA stage 0 onward can de-risk the process and the clients liability.

Our role is often seen as diminished, where in fact the management of BIM data/models, and the application of technical detail to RIBA stage 2/3 and into 4 allows us to protect out clients and ourselves from costly and risky processes of design and to create more coordinated data set from the outset, to challenge other consultants and avoid costly technical failures at an early stage in ‘virtual build’ environment.

Chris is a visiting critic at UCL The Bartlett, Manchester School of Architecture, The CASS and The RCA as well as being a former RIBA Award Judge and current AJ Award Jury Chair for Culture 2018/19.



Wimbledon Broadway



Lime Street

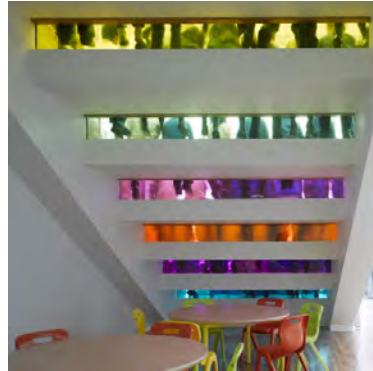

St Silas Primary



Brooks Building MMU Manchester



Riverside Quarter London

Key Experience

- Key Practice Leadership role
- Design Director + Board member
- People Leadership role/career mentor
- Multi Disciplinary project Director
- Thought leader and 'face' for Capita ESA Architects (220 staff UK)
- Press and PR/Marketing role
- Client relationships
- Highly creative; leading cultural change
- Commercially aware; core business skills
- Multi Sector experience; Schools to Offices
- Master-planning/Urban design
- Partnering/Developer strategy; public + private
- RIBA Practice Council member NW region
- RIBA Judge 2014/16
- AJ awards judge 2016/17/18

- AJ100 Awards Judge 2016 - 22
- CN Awards judge 2015/16
- Visiting Tutor/Critic - Royal College of Art
- Reviewer - Bartlett School of Architecture
- Visiting Tutor - Manchester School of Art
- Visiting Tutor - Sheffield University
- Speaker Ecobuild/Building Futures
- Contributor to AJ since 2013

Awards

- Civic Trust Awards Commendation 2013/14/15/16
- RIBA Regional Award 2013
- RIBA National Award 2013
- RIBA Client Award 2013
- BCO 2008 / 12

Professional Timeline

1994-1997

Glasgow School of Art

1997 - 1999

Sir James Strirling Michael Wilford + Ptns

1999 - 2001

Bartlett School of Architecture UCL

2002/3

BMW Brand Designer

2003-2009

Aedas (Associate Director)

2009 - 2016

Capita|ESA Architects (Design Director)

2016/17

CJCT Design Director

Assorted Skills + Talents*

Non Exec Director Slow Education Trust



Claire Lewis-Smith

Director + Founder

Claire was always creative and delights in colour, movement and designing. She grew up in the Scottish Highlands creating art work which enabled her to take place at the highly regarded Mackintosh School of Architecture, after which she went on to study at the Bartlett (UCL) five years after Chris.

Between school and higher education she travelled in the late 1990's as part of Project Trust, an outreach organisation working across the globe, to teach English at a University in Guangzhou, Guangdong, China.

Claire's sense of adventure, love of travel and of experiencing other cultures, along with her commitment to expanding her design own horizons took her back to the Glasgow School of Art where her work was intelligent, considered, and often radical.

At the Bartlett (UCL) Claire chose to work in a unit focussed on digital film media and manipulation of form in space leading to many final pieces which were more film than architecture. Her skills in VR and CGI are now key to the practices work as it expands into VR and augmented reality as a tool in design.

Claire worked at the highly regarded practice of BRT Architects in Hamburg between universities, part of a team engaged in high end retail and office designs across Germany, but with a focus on the brick built northern port of Hamburg where she lived and learnt to speak (and build) in German.

Claire's work has always been meticulous with a focus on detailed delivery of projects, as well as working with occupiers and end users to create workplace and office fit outs which can be used to deliver a wide platform of work-styles.

Her work with specialist interiors teams on Stryker and Subsea 7 led to a role at Buckley Gray Yeoman where she worked on a number of striking office refurbishments including Herbal House and The Minster Building (once Minster Court) in the City of London. These roles at both Capita|ESA and Buckley Gray Yeoman led to a refined eye for composition, and a world class knowledge of products and innovative material detailing.

Claire is a skilled project manager leading the delivery of the clean manufacturing combined HQ for medical supplies company Stryker as well as then developing the full suite of interior spaces from auditorium to refectory at drilling specialist Subsea 7 new HQ in Surrey.

Over the last two years Claire has been working with a bespoke London florist to develop new ways of delivery/client management in a fast-moving high-end retail environment as well as creating AST* with Chris, her partner.

Fluent in German and French Claire is a skilled communicator and leads the companies direction in marketing and business development across Europe.



Fountain Street, Manchester



Subsea 7, Surrey



Stryker HQ, Newbury



Saipem, Kingston upon Thames



Alakati, Cyprus

Key Experience

- Architectural Design
- Concept Design
- Technical Design
- Multi-Disciplinary Consultation and Project Working
- Client and Stakeholder Engagement
- Hand Sketching & Rendering
- CAD / BIM (Revit)
- Visualisation (Digital / Hand Sketching)
- Masterplanning & Urban Design
- Desktop Publishing
- Business Development
- Competitions,
- Design Review
- Technical Advisor Role
- Community / Stakeholder Engagement
- Concept Designs for Project Realisation
- Practice Management / Operations / Logistics

Awards

- 2012 Winner of the Construction Excellence “Best Value” award.
- Winner BCO regional Office award (South East)

Professional Timeline

1999-2007
The Mackintosh School of Architecture
 2004 - 2006
The Bartlett School of Architecture
 2004 (7 months)
Bothe Richter Teherani (BRT) - Hamburg
 2008-2009
University of Westminster
 2006 - 2015
Capita|ESA Architects - London (Project Architect)
 2015 - 2016
Buckley Gray Yeoman - London (Project Architect)
 2016 - 2017
5Plus Architects (Project Architect)

Assorted Skills + Talents*



Duncan Hammond

Design Director

Duncan is a motivated, dedicated and passionate award winning Architect with 20 years in practice, ARB registered for 11 years, with a wide range of transferable and adaptable skills.

His current role as Design Director within the practice recognises a particular set of skills and activities around early concept design and strategic thinking across multiple sectors. This is very much a client facing role and involves listening and research to gain a detailed understanding of the client and project brief.

Duncan's style can be described as 'Holistic' and 'Instinctive'; highly conceptual yet grounded. He has a strong command of plan, form and context and an enthusiastic and positive approach to design. He seeks efficiency and simplicity in a project and the enjoyment of its creation. Duncan also has a strong interest in the 'esoteric' nature of buildings and spaces and his natural inclination is to explore the big picture and smallest details simultaneously.

Duncan has worked within collaborative multidisciplinary environments for 19 years, over 10 of which he worked alongside Chris Boyce, and learned valuable lessons in multidisciplinary design and delivery. He is a highly conceptual yet grounded, a balanced viewpoint gained from a 10 year training period. Duncan loves to sketch by hand yet he has a close relationship with CAD and has been a strong proponent of BIM for over 14 years.

Duncan has a strong working knowledge of computer aided design and presentation techniques.

He is experienced in the leadership of design teams, often taking the lead design role. Passionate for the 'quality' of the end product whether that is the building, the space, or just a design document.

Duncan has also acted as Architect judge for the RIBA (NW) and is a member of both the RIBA NW Communications Committee and the Practice Committee.

Duncan believes that lessons learned through the various sectors can be transferred across to other sectors and that spaces should be designed for flexible multi-use as a means of increasing sustainability within the built environment.

The perseverance and dedication needed to achieve professional qualification has given me a strong work ethic, yet Duncan always strives to find enjoyment in the process, for himself, his colleagues and AST*'s clients.

Outside of work, he enjoys various physical pursuits, with a passion for electronic music and travel.



Olive Primary School



10 Duke Street



Southall Masterplan



St Silas Primary School



Roe Lee Primary School

Key Experience

- Architectural Design
- Concept Design
- Technical Design
- Multi-Disciplinary Consultation and Project Working
- Client and Stakeholder Engagement
- Hand Sketching & Rendering
- CAD / BIM (Revit)
- Visualisation (Digital / Hand Sketching)
- Masterplanning & Urban Design
- Desktop Publishing
- Project Bid -Lead and Management
- Business Development
- Staff and Student Mentoring
- RIBA Practice Committee
- RIBA Communications Committee
- RIBA Awards Judge

- Competitions,
- Design Review
- Technical Advisor Role
- Community / Stakeholder Engagement
- Concept Designs for Project Realisation
- Infrastructure
- Development strategy
- Practice Management / Operations / Logistics

Awards

- Civic Trust Awards Commendation 2013/14/15/16
- RIBA Regional Award 2013
- RIBA National Award 2013

Professional Timeline

1997-2007

Leeds Metropolitan University

1998 - 2004

Richard Stirrup Associates

2004 - 2015

Capita Property & Infrastructure (Architect / Associate)

2015 - 2016

Croft Goode Architects (Design Associate)

Assorted Skills + Talents*



ASSORTED SKILLS + TALENTS

3 Cobourg Street
Manchester
M1 3GY
+44 161 713 0517

48 Charlotte Street
London
W1T 2NS
+44 203 701 0403

Architecture
Design
Strategy
Narrative
Communication

www.assortedskillstalents.com